

INSTRUCTIONS IMPORTANT SAFEGUARDS

When using electrical equipment, basic safety precautions should always be followed including the following:

1. **READ AND FOLLOW ALL SAFETY INSTRUCTIONS**
2. Disconnect power before performing work on electrical equipment.
3. Do not use outdoors.
4. Use caution when servicing batteries.
5. Equipment should be mounted in locations and at heights where unauthorized personnel will not readily subject it to tampering.
6. The use of accessory equipment not recommended by Beghelli Inc., may cause an unsafe condition, and will void the unit's warranty.
7. Do not use this equipment for other than its intended purpose.
8. Servicing of this equipment should be performed by qualified service personnel.
9. **SAVE THESE INSTRUCTIONS!**

First, complete **A Common Mounting Steps** (page 2) before proceeding to mounting options shown below.

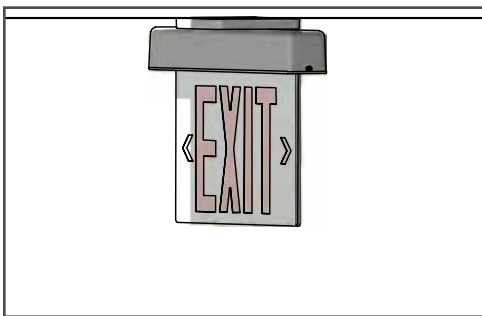

Surface Ceiling Mounting,
See page 3

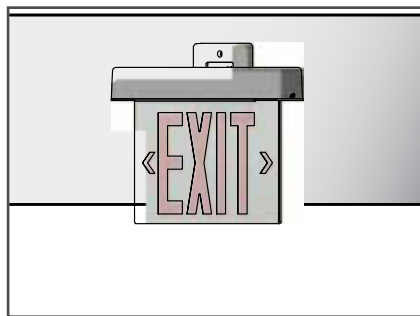

Surface Wall Mounting,
See page 3

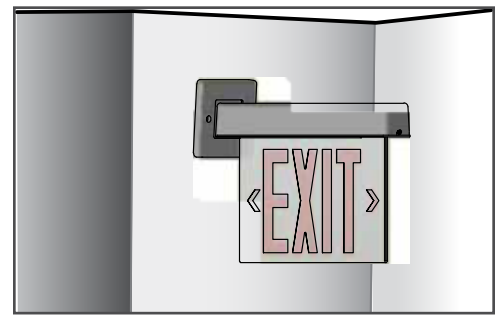

Surface End Mounting,
See page 4

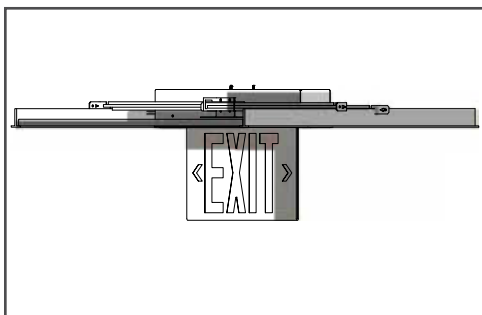

T-Bar Mounting,
See page 5

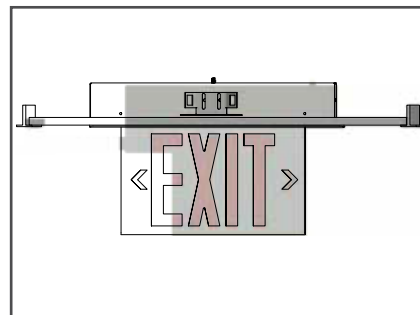

Ceiling Recessed Mounting,
See page 6

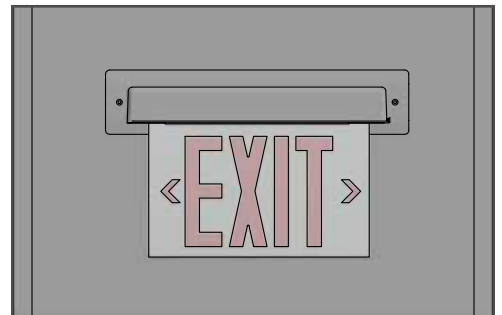

Wall Recessed Mounting,
See page 6

Components

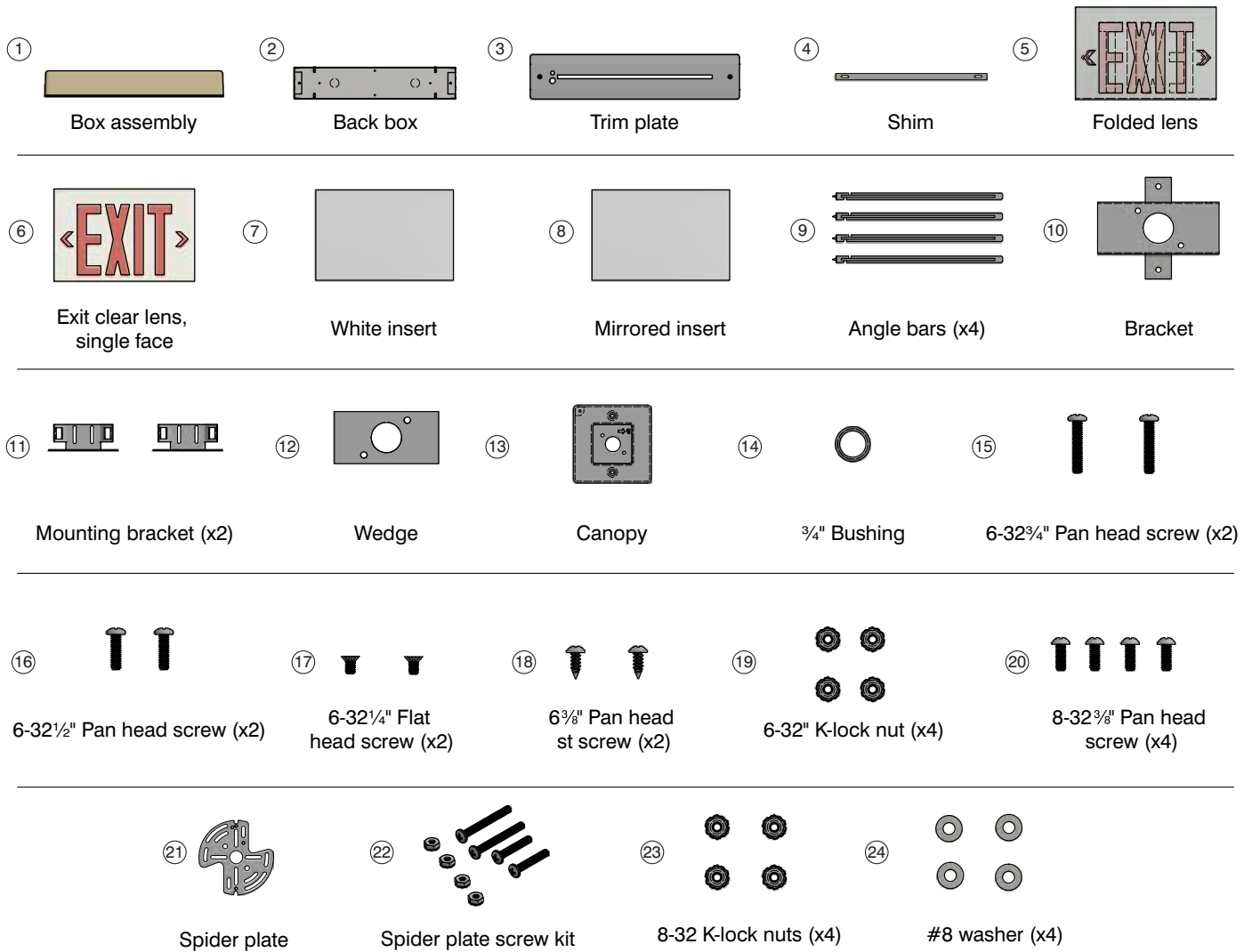

INSTALLATION

A Common Mounting Steps:

1. Remove cover from box assembly ① by removing screw on end of box assembly.

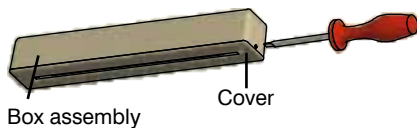

5. Remove protective sleeve from LED strip.

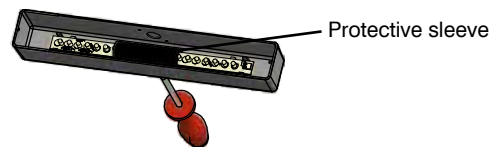

2. Knock out appropriate holes for mounting and install 3/4" bushing ⑭ in entry hole and feed wires through.

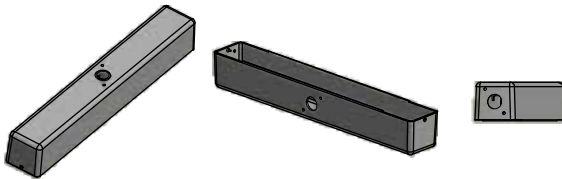

6. For self-powered sign, plug battery into LED board.
7. Select lens. Slide in white insert ⑦ or mirrored insert ⑧. Use one shim on lens ⑤.

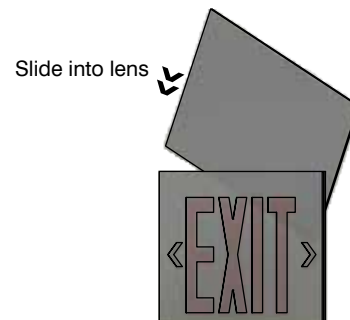

3. For t-bar or ceiling recessed, knock out top holes.
4. For ceiling, knock out top, for surface end, knock out end, for surface wall, knock out side.

8. Peel backing off shim (4) and align with top of lens and stick.

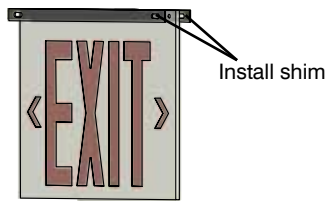

9. Slide lens assembly into cover (1).

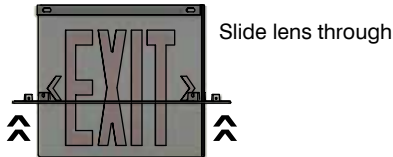

10. Secure using two 3/4" pan head screws (15) and k-lock nuts (19).

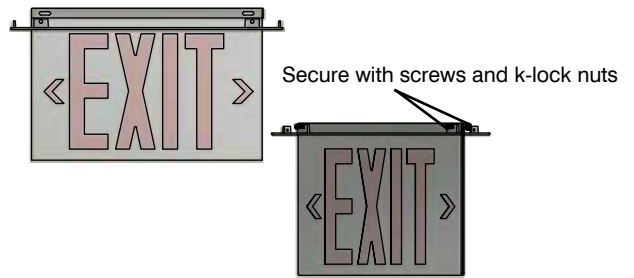

Surface Ceiling Mounting:

1. Install canopy (13) to box using two 1/2" pan head screws (16) and k-lock nuts (19).

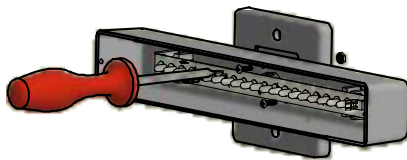

3. Secure with screw.

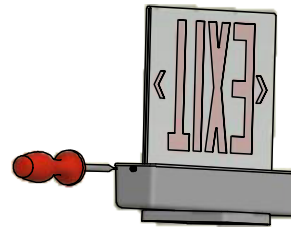

2. Install cover and lens assembly into box.

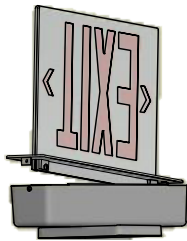

4. Thread wires through the spider plate. (21)

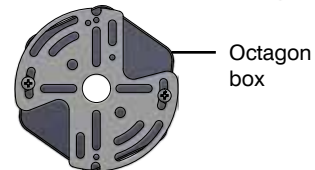

5. Make electrical connections (see **Wiring Diagram**, page 6).

6. Adjust the orientation of the spider plate to proper position. (22)

Surface Wall Mounting:

1. Position wedge (12) and canopy with the thick side of wedge up.

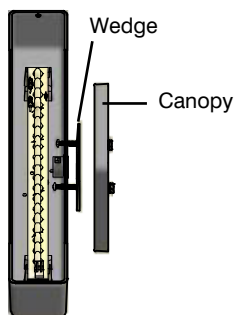

2. Secure with two 1/2" pan head screws (16) and k-lock nuts (19).

3. Install cover and lens assembly into box.

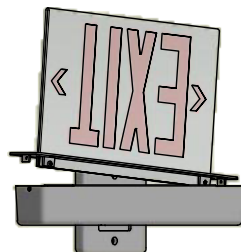

4. Secure with screw.

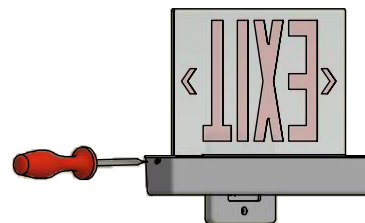

5. Thread wires through the spider plate. (21)

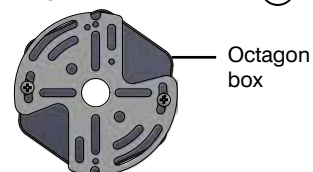

6. Make electrical connections (see **Wiring Diagram**, page 6).

7. Adjust the orientation of the spider plate to proper position. (22)

Surface End Mounting:

1. Position canopy (13).
2. Secure with two 1/2" pan head screws (16) and k-lock nuts (19).

NOTE:
Orientation
of canopy
"up".

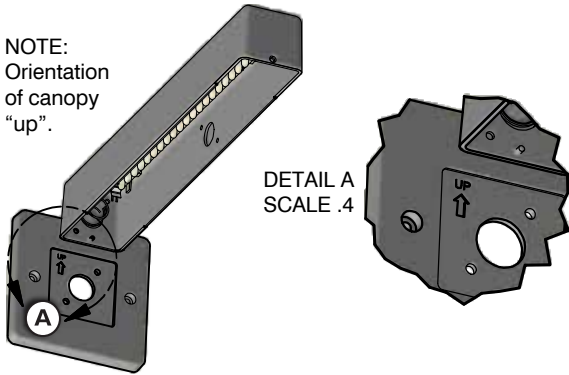

4. Secure with screw.

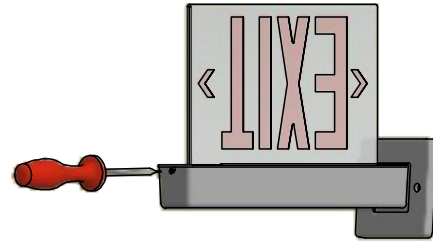

3. Install cover and lens assembly into box.

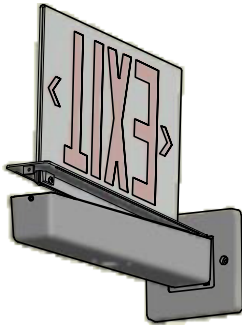

5. Thread wires through the spider plate. (21)

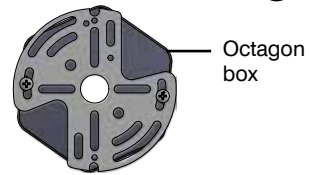

6. Make electrical connections (see **Wiring Diagram**, page 6).
7. Adjust the orientation of the spider plate to proper position. (22)

NOTE: Follow steps 1 through 8 in **A** Common Mounting Steps before proceeding onto **B** Common Steps for Recessed Mounting.

B Common Steps for Recessed Mounting:

1. Use back box (2) as template cut opening.

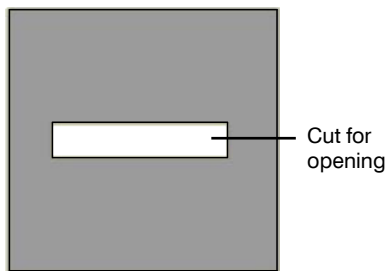

2. Knock out entry hole in back box (2).

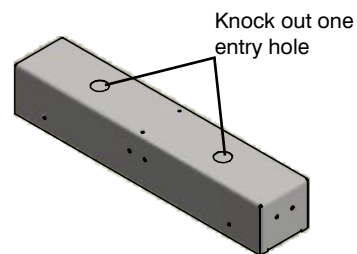

3. Install strain-relief (not supplied).

T-Bar Mounting:

1. Install two mounting brackets (11) to back box (2) using four 3/8" pan head screws (20), washers (24), and k-lock nuts (23).
NOTE: Mounting brackets can be installed on sides or ends of backbox.

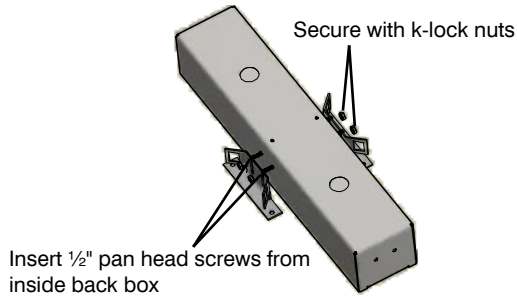

2. Slide four angle bars (9) into mounting brackets (11).
3. Install backbox assembly in ceiling.

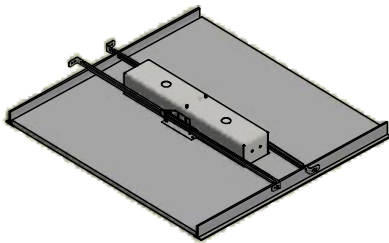

4. Install bracket (10) to top of box assembly (1) using two 1/2" pan head screws (16) and k-lock nuts (19).

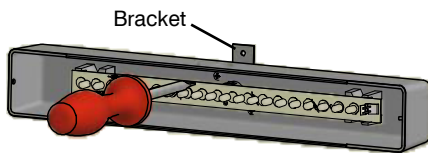

5. Install cover and lens assembly into box.

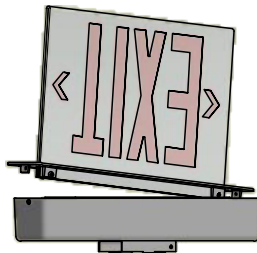

6. Secure with screw.

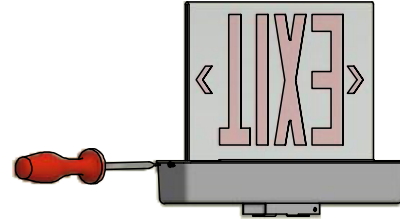

7. Make electrical connections (see **Wiring Diagram**, page 6).
8. Position assembly up into back box (2) and secure bracket (10) to back box using two 3/8" self tapping screws (18).

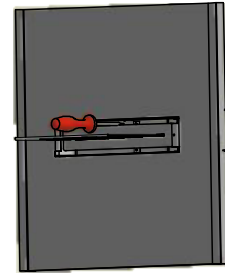

9. Slide trim plate (3) over lens and secure with 7/16" flat head screws (17).

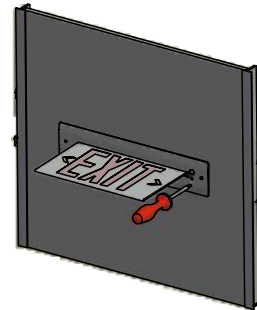

Ceiling Recessed Mounting:

For Ceiling Recessed Mounting, follow **T-Bar Mounting** instructions and exclude angle bars (9).

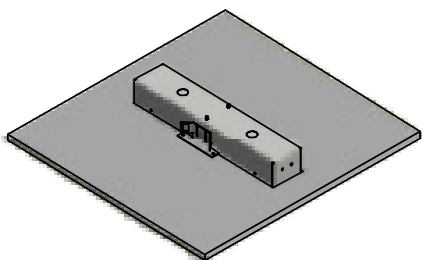

Wall Recessed Mounting:

1. Drill out three holes on trim plate (3). Use marks on trim plate 7/8" diameter mounting holes and two 3/16" diameter mounting holes.

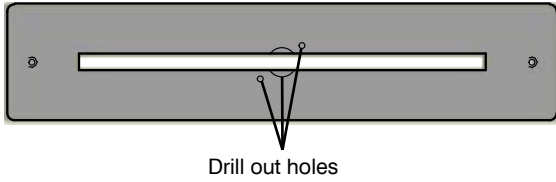

2. Position wedge (12) and trim plate (3) with thick side of wedge up.

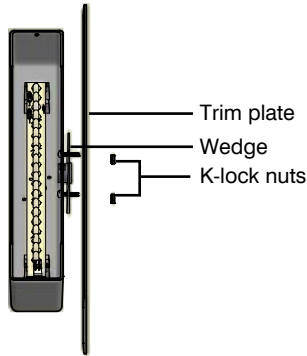

3. Secure with two 3/8" pan head screws (20) and k-lock nuts (19).
4. Install cover lens assembly into box.

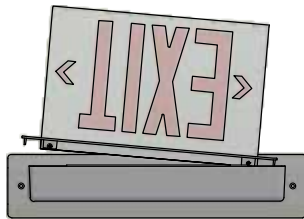

5. Secure with screw.

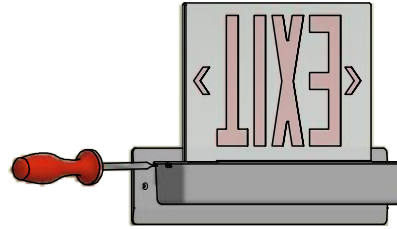

6. Make electrical connections (see **Wiring Diagram**, page 6).
7. Position assembly to back box (2) and secure using 7/16" flat head screws (17).



Wiring Diagram

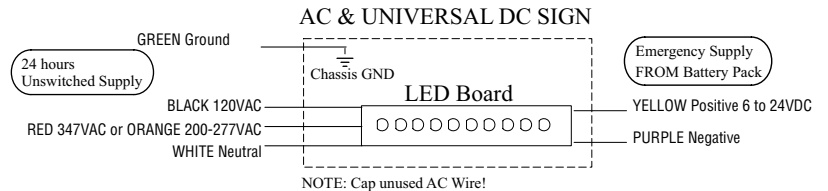
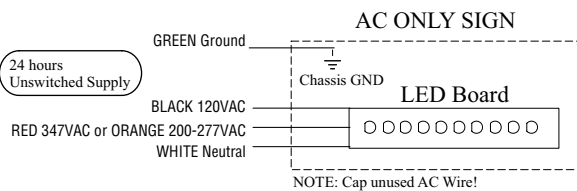
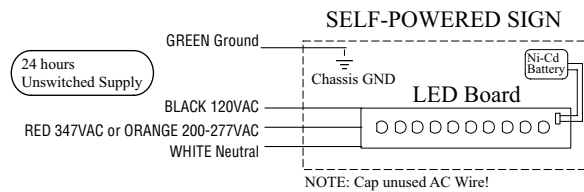
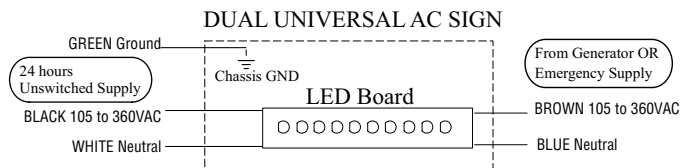

MAINTENANCE

1. Code requires that the equipment be tested every 30 days for 30 seconds, and that written records be maintained. Further, the equipment is to be tested once a year for the required time duration. The the equipment is to be repaired whenever the equipment fails to operate as intended during the duration test. Written records of test results and any repairs made must be maintained. Beghelli Inc. strongly recommends compliance with these code requirements.
 2. The lamps listed herein when used according to the instructions with this unit are in accordance with the requirements of CSA Standard C22.2, No. 141 – Unit Equipment for Emergency Lighting.
 3. Clean faceplates/lenses on a regular basis.
- NOTE: Always turn off AC power before servicing. The servicing of any parts should be performed by qualified service personnel. The use of replacement parts not furnished by Beghelli Inc., may cause equipment failure and will void the warranty.
-

TROUBLESHOOTING

EXIT SIGN DOES NOT COME ON AT ALL

1. Check AC supply - be sure unit has 48 hour AC supply (unswitched).
 2. AC supply is OK and indicator light is out, replace PC Board Assembly.
 3. This could be the result of a switched AC supply to the unit (which has been turned off at some point).
-

SAVE THESE INSTRUCTIONS