

REPORT NUMBER: ITL68902

PAGE: 1 OF 7

ISSUE DATE: 06/21/11

PREPARED FOR: BEGHELLI

CATALOG NUMBER: XLPLED1HO

LUMINAIRE: MOLDED WHITE PLASTIC HOUSING, TWO MOLDED WHITE PLASTIC SWIVEL HEAD ASSEMBLIES, EACH HEAD ASSEMBLY CONSISTS OF: MOLDED WHITE PLASTIC HOUSING, ONE CIRCUIT BOARD WITH 12 LEDS, MOLDED PLASTIC REFLECTOR WITH SPECULAR FINISH AND ONE APERTURE PER LED, CLEAR PRISMATIC PLASTIC LENS. ONLY ONE HEAD ASSEMBLY ENERGIZED FOR THIS TEST.

LAMPS: TWELVE WHITE LIGHT EMITTING DIODES (LEDS) EACH WITH CLEAR CYLINDRICAL INTEGRAL LENS WITH HEMISPHERICAL END, VERTICAL BASE-UP POSITION.

TOTAL INPUT WATTS = 0.788 AT 3.60 VOLTS DC  
MOUNTING: SURFACE

NOTE: DATA SHOWN IS ABSOLUTE FOR THE SAMPLE PROVIDED AT CLIENT REQUESTED INPUT VOLTAGE (3.6VDC) TO THE LAMP ASSEMBLY.

TEST PROCEDURE: IESNA LM-79-08

TEST DISTANCE = 25.25 FEET

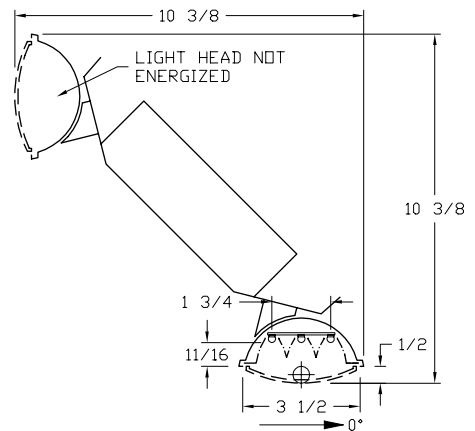

#### CANDELA DISTRIBUTION

#### FLUX

	0.0	22.5	45.0	67.5	90.0	
0	95.7	95.7	95.7	95.7	95.7	
5	100.0	98.6	97.5	94.7	88.6	9.4
15	65.9	60.4	76.8	86.7	86.7	20.7
25	33.3	33.8	43.1	35.8	37.1	17.3
35	15.1	12.0	16.4	20.5	21.4	10.7
45	2.3	3.3	3.3	9.7	7.6	4.5
55	0.8	0.9	1.4	2.4	2.6	1.5
65	0.5	0.5	0.6	0.8	1.2	0.7
75	0.3	0.3	0.3	0.4	0.5	0.4
85	0.1	0.1	0.2	0.2	0.2	0.2
90	0.0	0.0	0.1	0.1	0.2	
95	0.0	0.0	0.0	0.0	0.1	0.0
105	0.0	0.0	0.0	0.0	0.0	0.0
115	0.0	0.0	0.0	0.0	0.0	0.0
125	0.0	0.0	0.0	0.0	0.0	0.0
135	0.0	0.0	0.0	0.0	0.0	0.0
145	0.0	0.0	0.0	0.0	0.0	0.0
155	0.0	0.0	0.0	0.0	0.0	0.0
165	0.0	0.0	0.0	0.0	0.0	0.0
175	0.0	0.0	0.0	0.0	0.0	0.0
180	0.0	0.0	0.0	0.0	0.0	0.0

#### ZONAL LUMEN SUMMARY

ZONE	LUMENS	% FIXT
0- 30	47.4	72.5
0- 40	58.1	88.8
0- 60	64.1	98.0
0- 90	65.4	99.9
90-120	0.0	0.1
90-130	0.0	0.1
90-150	0.0	0.1
90-180	0.0	0.1
0-180	65.4	100.0

EFFICACY = 83.0 Lm/W  
CIE TYPE - DIRECT

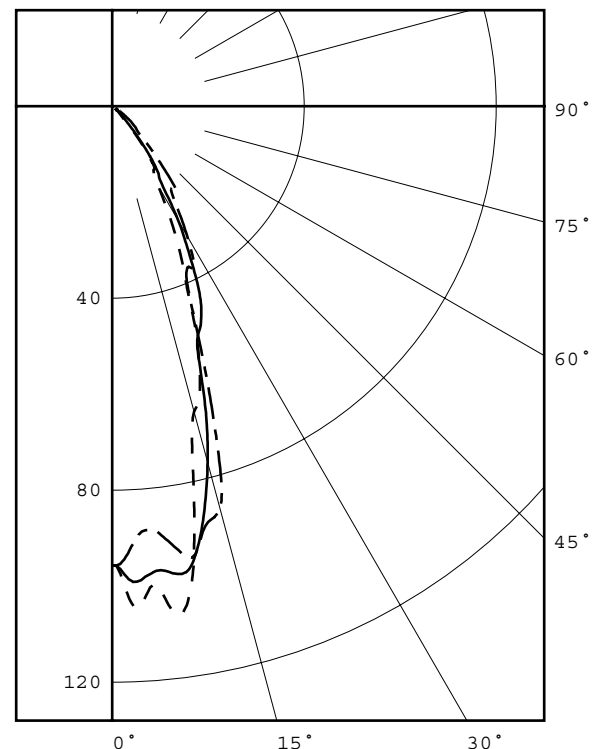

#### LEGEND:

0-deg: - - - - -  
45-deg: - - - - -  
90-deg: - - - - -

Checked M. KLOPF  
Approved R. BEATTIE  
Lighting Engineer

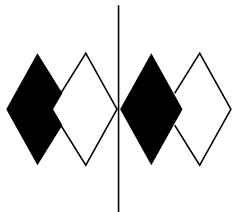

**itl boulder**

THE LIGHT CENTER OF THE INDUSTRY SINCE 1955



INDEPENDENT TESTING LABORATORIES, INC.  
3386 LONGHORN ROAD, BOULDER, CO 80302 USA

PHONE: (303)442-1255 • FAX: (303)449-5274 • E-MAIL: [itl@itlboulder.com](mailto:itl@itlboulder.com) • WEBSITE: [www.itlboulder.com](http://www.itlboulder.com)

REPORT NUMBER: ITL68902  
ISSUE DATE: 06/21/11  
PREPARED FOR: BEGHELLI

PAGE: 2 OF 7

PLANE : 0-DEG 90-DEG  
SPACING CRITERIA : 0.68 0.71



INDEPENDENT TESTING LABORATORIES, INC.  
3386 LONGHORN ROAD, BOULDER, CO 80302 USA

PHONE: (303)442-1255 • FAX: (303)449-5274 • E-MAIL: [itl@itlboulder.com](mailto:itl@itlboulder.com) • WEBSITE: [www.itlboulder.com](http://www.itlboulder.com)

REPORT NUMBER: ITL68902  
ISSUE DATE: 06/21/11  
PREPARED FOR: BEGHELLI

PAGE: 3 OF 7

CANDELA DISTRIBUTION  
LATERAL ANGLE

	0.0	22.5	45.0	67.5	90.0
0.0	95.7	95.7	95.7	95.7	95.7
0.5	95.7	95.7	95.7	95.7	95.7
1.0	97.4	97.1	96.4	95.7	95.4
1.5	100.1	99.5	97.6	95.4	94.5
2.0	102.8	101.7	98.6	94.9	93.3
2.5	104.4	103.0	99.2	94.4	91.8
3.0	104.6	103.2	99.2	94.0	90.7
3.5	103.7	102.3	98.9	93.8	89.5
4.0	102.1	101.0	98.3	93.6	88.8
4.5	100.6	99.5	97.9	93.9	88.6
5.0	100.0	98.6	97.5	94.7	88.6
5.5	100.8	98.6	97.2	95.5	88.8
6.0	102.5	99.8	97.2	96.4	89.1
6.5	104.8	101.8	97.4	97.2	89.9
7.0	106.4	103.3	97.8	98.3	90.8
7.5	106.9	103.8	98.2	99.3	91.6
8.0	106.4	103.4	98.4	99.7	92.6
8.5	105.1	102.0	98.5	100.0	93.5
9.0	103.1	99.8	98.3	100.0	94.6
9.5	100.6	97.1	97.7	99.7	95.1
10.0	97.5	93.9	96.6	99.0	95.5
11.0	89.7	86.6	93.5	96.0	93.7
12.0	81.7	78.8	89.9	92.8	90.7
13.0	74.2	71.3	85.7	89.9	88.9
14.0	68.8	64.7	81.4	87.7	88.2
15.0	65.9	60.4	76.8	86.7	86.7
16.0	64.6	58.3	72.0	85.2	82.8
17.0	62.5	56.7	66.8	81.5	75.8
18.0	59.1	54.7	60.8	76.4	68.2
19.0	55.5	52.5	55.2	69.6	61.1
20.0	51.7	49.6	51.8	61.9	54.4
22.5	40.6	41.7	48.4	45.0	41.4
25.0	33.3	33.8	43.1	35.8	37.1
27.5	26.0	27.1	34.9	32.1	37.2
30.0	18.9	20.3	27.6	30.7	31.2
32.5	16.0	14.6	19.2	25.7	25.4
35.0	15.1	12.0	16.4	20.5	21.4
37.5	11.0	10.3	12.3	16.8	22.0
40.0	7.0	7.7	8.0	16.2	16.2
42.5	3.1	6.4	5.2	13.9	11.5
45.0	2.3	3.3	3.3	9.7	7.6
47.5	1.5	2.3	2.4	5.8	6.6
50.0	1.2	1.4	1.8	4.0	5.3
52.5	1.0	1.1	1.4	3.1	3.8
55.0	0.8	0.9	1.4	2.4	2.6
57.5	0.7	0.8	1.1	1.6	1.9
60.0	0.6	0.7	0.8	1.2	1.6
62.5	0.5	0.6	0.7	1.0	1.3
65.0	0.5	0.5	0.6	0.8	1.2
67.5	0.4	0.4	0.5	0.7	1.1
70.0	0.4	0.4	0.5	0.6	1.0
72.5	0.3	0.4	0.4	0.5	0.6
75.0	0.3	0.3	0.3	0.4	0.5
77.5	0.2	0.3	0.3	0.4	0.4
80.0	0.2	0.2	0.3	0.3	0.3
82.5	0.2	0.2	0.2	0.2	0.3
85.0	0.1	0.1	0.2	0.2	0.2
87.5	0.1	0.1	0.1	0.1	0.2
90.0	0.0	0.0	0.1	0.1	0.2
92.5	0.0	0.0	0.1	0.1	0.2
95.0	0.0	0.0	0.0	0.0	0.1
97.5	0.0	0.0	0.0	0.0	0.1
100.0	0.0	0.0	0.0	0.0	0.0
102.5	0.0	0.0	0.0	0.0	0.0
105.0	0.0	0.0	0.0	0.0	0.0

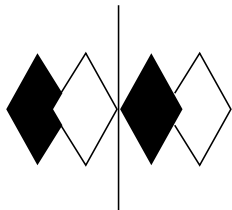

**itl boulder**

THE LIGHT CENTER OF THE INDUSTRY SINCE 1955



INDEPENDENT TESTING LABORATORIES, INC.  
3386 LONGHORN ROAD, BOULDER, CO 80302 USA

PHONE: (303)442-1255 • FAX: (303)449-5274 • E-MAIL: [itl@itlboulder.com](mailto:itl@itlboulder.com) • WEBSITE: [www.itlboulder.com](http://www.itlboulder.com)

REPORT NUMBER: ITL68902  
ISSUE DATE: 06/21/11  
PREPARED FOR: BEGHELLI

PAGE: 4 OF 7

CANDELA DISTRIBUTION  
LATERAL ANGLE

	0.0	22.5	45.0	67.5	90.0
107.5	0.0	0.0	0.0	0.0	0.0
110.0	0.0	0.0	0.0	0.0	0.0
115.0	0.0	0.0	0.0	0.0	0.0
120.0	0.0	0.0	0.0	0.0	0.0
125.0	0.0	0.0	0.0	0.0	0.0
130.0	0.0	0.0	0.0	0.0	0.0
135.0	0.0	0.0	0.0	0.0	0.0
140.0	0.0	0.0	0.0	0.0	0.0
145.0	0.0	0.0	0.0	0.0	0.0
150.0	0.0	0.0	0.0	0.0	0.0
155.0	0.0	0.0	0.0	0.0	0.0
160.0	0.0	0.0	0.0	0.0	0.0
165.0	0.0	0.0	0.0	0.0	0.0
170.0	0.0	0.0	0.0	0.0	0.0
175.0	0.0	0.0	0.0	0.0	0.0
180.0	0.0	0.0	0.0	0.0	0.0



INDEPENDENT TESTING LABORATORIES, INC.  
3386 LONGHORN ROAD, BOULDER, CO 80302 USA

PHONE: (303)442-1255 • FAX: (303)449-5274 • E-MAIL: [itl@itlboulder.com](mailto:itl@itlboulder.com) • WEBSITE: [www.itlboulder.com](http://www.itlboulder.com)

REPORT NUMBER: ITL68902  
ISSUE DATE: 06/21/11  
PREPARED FOR: BEGHELLI

PAGE: 5 OF 7

5-DEGREE  
ZONAL LUMEN SUMMARY

0- 5	2.3
5- 10	7.1
10- 15	10.0
15- 20	10.7
20- 25	9.3
25- 30	7.9
30- 35	6.1
35- 40	4.6
40- 45	3.0
45- 50	1.5
50- 55	0.9
55- 60	0.6
60- 65	0.4
65- 70	0.3
70- 75	0.2
75- 80	0.2
80- 85	0.1
85- 90	0.1
90- 95	0.0
95-100	0.0
100-105	0.0
105-110	0.0
110-115	0.0
115-120	0.0
120-125	0.0
125-130	0.0
130-135	0.0
135-140	0.0
140-145	0.0
145-150	0.0
150-155	0.0
155-160	0.0
160-165	0.0
165-170	0.0
170-175	0.0
175-180	0.0

10-DEGREE  
ZONAL LUMEN SUMMARY

0- 10	9.4
0- 20	30.1
0- 30	47.4
0- 40	58.1
0- 50	62.6
0- 60	64.1
0- 70	64.8
0- 80	65.2
0- 90	65.4
0-100	65.4
0-110	65.4
0-120	65.4
0-130	65.4
0-140	65.4
0-150	65.4
0-160	65.4
0-170	65.4
0-180	65.4



INDEPENDENT TESTING LABORATORIES, INC.  
3386 LONGHORN ROAD, BOULDER, CO 80302 USA

PHONE: (303)442-1255 • FAX: (303)449-5274 • E-MAIL: [itl@itlboulder.com](mailto:itl@itlboulder.com) • WEBSITE: [www.itlboulder.com](http://www.itlboulder.com)

REPORT NUMBER: ITL68902

PAGE: 6 OF 7

ISSUE DATE: 06/21/11

PREPARED FOR: BEGHELLI

# COEFFICIENTS OF UTILIZATION - ZONAL CAVITY METHOD

EFFECTIVE FLOOR CAVITY REFLECTANCE 0.20

RC	80				70				50			30			10			0
RW	70	50	30	10	70	50	30	10	50	30	10	50	30	10	50	30	10	0
0	119	119	119	119	116	116	116	116	111	111	111	106	106	106	102	102	102	100
1	113	111	108	106	111	108	106	104	104	103	101	101	99	98	97	96	95	93
2	108	103	99	95	106	101	98	94	98	95	92	95	93	90	92	90	88	87
3	103	96	91	87	101	95	90	87	92	88	85	90	86	84	87	85	82	81
4	98	90	85	80	96	89	84	80	87	82	79	85	81	78	83	80	77	76
5	93	85	79	75	91	84	78	74	82	77	74	80	76	73	79	75	72	71
6	88	80	74	70	87	79	73	69	77	73	69	76	72	68	75	71	68	67
7	84	75	69	65	83	75	69	65	73	68	65	72	68	64	71	67	64	63
8	81	71	65	62	79	71	65	61	70	65	61	69	64	61	68	64	61	59
9	77	68	62	58	76	67	62	58	66	61	58	65	61	58	65	60	57	56
10	74	64	59	55	73	64	59	55	63	58	55	62	58	55	62	58	55	53

ALL CANDELA, LUMENS, LUMINANCE, AND VCP VALUES IN THIS REPORT ARE BASED ON ABSOLUTE PHOTOMETRY. THE COEFFICIENT OF UTILIZATION VALUES ARE BASED ON THE TOTAL ABSOLUTE LUMEN OUTPUT OF THIS LUMINAIRE SAMPLE.

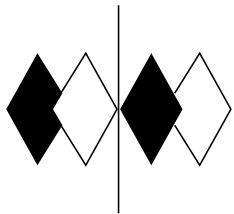

**itl boulder**  
THE LIGHT CENTER OF THE INDUSTRY SINCE 1955



INDEPENDENT TESTING LABORATORIES, INC.  
3386 LONGHORN ROAD, BOULDER, CO 80302 USA

PHONE: (303)442-1255 • FAX: (303)449-5274 • E-MAIL: [itl@itlboulder.com](mailto:itl@itlboulder.com) • WEBSITE: [www.itlboulder.com](http://www.itlboulder.com)

REPORT NUMBER: ITL68902  
ISSUE DATE: 06/21/11  
PREPARED FOR: BEGHELLI

PAGE: 7 OF 7

ADDRESS: 3250 Corporate Way  
Miramar, FL 33025

THIS ITL REPORT WITH THE USE OF THE NVLAP LOGO SHALL NOT BE USED BY THE CLIENT TO CLAIM PRODUCT CERTIFICATION, APPROVAL, OR ENDORSEMENT BY NVLAP, NIST, OR ANY AGENCY OF THE FEDERAL GOVERNMENT.